

Filter elements

acc. DIN 24 550

for inline filters

Standard seal NBR

for filter housings acc. DIN 24 550

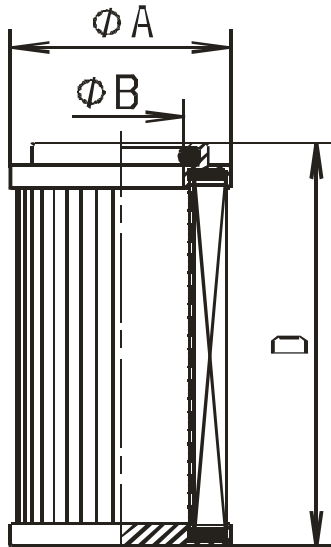

- Smx / Smx vst:** Single-use filter elements made of anorganic filter material
Retention rates 3, 6, 10, 25 μm ($\beta_x \geq 75$)
- Drg / Drg vst :** Cleanable filter elements made of stainless steel wire mesh (for retention rates $< 40 \mu\text{m}$ preferably in an ultrasonic bath)
Mesh sizes 10, 25, 40, 60, 100 μm
- Mic :** Single-use filter elements made of organic filter material
Retention rates 10, 25 μm
- End caps :** Steel, galvanized and yellow chromated
- Inner tube :** Steel, galvanized and yellow chromated

Nominal-size	[] Type designation		Order - no.			() Filter surface		
	Smx 3 Δp 20 bar	Smx 6 Δp 20 bar	Smx 10 Δp 20 bar	Smx 16 Δp 20 bar	Smx 25 Δp 20 bar	Measures in mm		
						A	B	D
40	[Pi 21004 DN] 826.092.9 (475 cm ²)	[Pi 22004 DN] 796.085.9 (475 cm ²)	[Pi 23004 DN] 792.557.1 (475 cm ²)	[Pi 24004 DN] 826.093.7 (475 cm ²)	[Pi 25004 DN] 826.094.5 (475 cm ²)	45	22	100
63	[Pi 21006 DN] 826.096.0 (835 cm ²)	[Pi 22006 DN] 796.086.7 (835 cm ²)	[Pi 23006 DN] 792.558.9 (835 cm ²)	[Pi 24006 DN] 826.097.8 (835 cm ²)	[Pi 25006 DN] 826.098.6 (835 cm ²)	45	22	160
100	[Pi 21010 DN] 822.747.2 (1375 cm ²)	[Pi 22010 DN] 796.087.5 (1375 cm ²)	[Pi 23010 DN] 792.559.7 (1375 cm ²)	[Pi 24010 DN] 826.100.0 (1375 cm ²)	[Pi 25010 DN] 826.101.8 (1375 cm ²)	45	22	250
160	[Pi 21016 DN] 826.103.4 (2530 cm ²)	[Pi 22016 DN] 796.082.6 (2530 cm ²)	[Pi 23016 DN] 792.560.5 (2530 cm ²)	[Pi 24016 DN] 826.104.2 (2530 cm ²)	[Pi 25016 DN] 826.105.9 (2530 cm ²)	80	40	160
250	[Pi 21025 DN] 822.751.4 (4020 cm ²)	[Pi 22025 DN] 796.083.4 (4020 cm ²)	[Pi 23025 DN] 792.561.3 (4020 cm ²)	[Pi 24025 DN] 826.107.5 (4020 cm ²)	[Pi 25025 DN] 826.108.3 (4020 cm ²)	80	40	250
400	[Pi 21040 DN] 822.752.2 (6770 cm ²)	[Pi 22040 DN] 796.084.2 (6770 cm ²)	[Pi 23040 DN] 792.562.1 (6770 cm ²)	[Pi 24040 DN] 826.110.9 (6770 cm ²)	[Pi 25040 DN] 826.111.7 (6770 cm ²)	80	40	400
630	[Pi 21063 DN] 796.151.9 (9300 cm ²)	[Pi 22063 DN] 794.369.9 (9300 cm ²)	[Pi 23063 DN] 792.563.9 (9300 cm ²)	[Pi 24063 DN] 796.152.7 (9300 cm ²)	[Pi 25063 DN] 796.153.5 (9300 cm ²)	100	60	400
1000	[Pi 21100 DN] 796.161.8 (14500 cm ²)	[Pi 22100 DN] 794.372.3 (14500 cm ²)	[Pi 23100 DN] 792.564.7 (14500 cm ²)	[Pi 24100 DN] 796.162.6 (14500 cm ²)	[Pi 25100 DN] 796.163.4 (14500 cm ²)	100	60	630

[] Type designation		Order - no.				() Filter surface		
Nominal-size	Smx vst 3	Smx vst 6	Smx vst 10	Smx vst 16	Smx vst 25	Measures in mm		
	Δp 210 bar	Δp 210 bar	Δp 210 bar	Δp 210 bar	Δp 210 bar	A	B	D
40	[Pi 71004 DN] 821.607.9 (445 cm ²)	[Pi 72004 DN] 796.015.6 (445 cm ²)	[Pi 73004 DN] 792.565.4 (445 cm ²)	[Pi 74004 DN] 821.608.7 (445 cm ²)	[Pi 75004 DN] 821.609.5 (445 cm ²)	45	22	100
63	[Pi 71006 DN] 821.613.7 (780 cm ²)	[Pi 72006 DN] 796.014.9 (780 cm ²)	[Pi 73006 DN] 792.566.2 (780 cm ²)	[Pi 74006 DN] 821.614.5 (780 cm ²)	[Pi 75006 DN] 821.615.2 (780 cm ²)	45	22	160
100	[Pi 71010 DN] 822.748.0 (1275 cm ²)	[Pi 72010 DN] 796.013.1 (1275 cm ²)	[Pi 73010 DN] 792.567.0 (1275 cm ²)	[Pi 74010 DN] 826.128.1 (1275 cm ²)	[Pi 75010 DN] 821.616.0 (1275 cm ²)	45	22	250
160	[Pi 71016 DN] 794.063.8 (1885 cm ²)	[Pi 72016 DN] 796.012.3 (1885 cm ²)	[Pi 73016 DN] 792.568.8 (1885 cm ²)	[Pi 74016 DN] 826.979.7 (1885 cm ²)	[Pi 75016 DN] 821.617.8 (1885 cm ²)	80	40	160
250	[Pi 71025 DN] 794.064.6 (3090 cm ²)	[Pi 72025 DN] 796.011.5 (3090 cm ²)	[Pi 73025 DN] 792.569.6 (3090 cm ²)	[Pi 74025 DN] 826.981.3 (3090 cm ²)	[Pi 75025 DN] 821.618.6 (3090 cm ²)	80	40	250
400	[Pi 71040 DN] 794.065.3 (5240 cm ²)	[Pi 72040 DN] 796.010.7 (5240 cm ²)	[Pi 73040 DN] 793.082.9 (5240 cm ²)	[Pi 74040 DN] 826.982.1 (5240 cm ²)	[Pi 75040 DN] 826.090.3 (5240 cm ²)	80	40	400
630	[Pi 71063 DN] 796.154.3 (7230 cm ²)	[Pi 72063 DN] 796.009.9 (7230 cm ²)	[Pi 73063 DN] 792.571.2 (7230 cm ²)	[Pi 74063 DN] 796.155.0 (7230 cm ²)	[Pi 75063 DN] 796.156.8 (7230 cm ²)	100	60	400
1000	[Pi 71100 DN] 796.164.2 (11450 cm ²)	[Pi 72100 DN] 796.008.1 (11450 cm ²)	[Pi 73100 DN] 792.572.0 (11450 cm ²)	[Pi 74100 DN] 796.165.9 (11450 cm ²)	[Pi 75100 DN] 796.166.7 (11450 cm ²)	100	60	630

Nominal-size	Mic 10	Mic 25				Measures in mm		
	Δp 20 bar	Δp 20 bar				A	B	D
40	[Pi 13004 DN] 792.969.8 (475 cm ²)	[Pi 15004 DN] 826.091.1 (475 cm ²)				45	22	100
63	[Pi 13006 DN] 792.970.6 (835 cm ²)	[Pi 15006 DN] 826.095.2 (835 cm ²)				45	22	160
100	[Pi 13010 DN] 792.971.4 (1375 cm ²)	[Pi 15010 DN] 826.099.4 (1375 cm ²)				45	22	250
160	[Pi 13016 DN] 792.972.2 (2530 cm ²)	[Pi 15016 DN] 826.102.6 (2530 cm ²)				80	40	160
250	[Pi 13025 DN] 792.973.0 (4020 cm ²)	[Pi 15025 DN] 826.106.7 (4020 cm ²)				80	40	250
400	[Pi 13040 DN] 792.974.8 (6770 cm ²)	[Pi 15040 DN] 826.109.1 (6770 cm ²)				80	40	400
630	[Pi 13063 DN] 792.975.5 (9300 cm ²)	[Pi 15063 DN] 796.150.1 (9300 cm ²)				100	60	400
1000	[Pi 13100 DN] 792.976.3 (14500 cm ²)	[Pi 15100 DN] 796.160.0 (14500 cm ²)				100	60	630

[] Type designation		Order - no.			() Filter surface			
Nominal-size	Drq 10	Drq 25	Drq 40	Drq 60	Drq 100	Measures in mm		
	Δp 20 bar	Δp 20 bar	Δp 20 bar	Δp 20 bar	Δp 20 bar	A	B	D
40	[Pi 33004 DN] 976.930.8 (475 cm ²)	[Pi 35004 DN] 976.930.8 (475 cm ²)	[Pi 36004 DN] 970.446.1 (475 cm ²)	[Pi 37004 DN] 611.690.9 (475 cm ²)	[Pi 38004 DN] 970.380.2 (475 cm ²)	45	22	100
63	[Pi 33006 DN] (835 cm ²)	[Pi 35006 DN] (835 cm ²)	[Pi 36006 DN] (835 cm ²)	[Pi 37006 DN] (835 cm ²)	[Pi 38006 DN] 613.236.9 (835 cm ²)	45	22	160
100	[Pi 33010 DN] (1375 cm ²)	[Pi 35010 DN] 973.576.2 (1375 cm ²)	[Pi 36010 DN] (1375 cm ²)	[Pi 37010 DN] (1375 cm ²)	[Pi 38010 DN] 939.467.7 (1375 cm ²)	45	22	250
160	[Pi 33016 DN] (2225 cm ²)	[Pi 35016 DN] 970.195.4 (2225 cm ²)	[Pi 36016 DN] 936.347.4 (2225 cm ²)	[Pi 37016 DN] 611.199.1 (2225 cm ²)	[Pi 38016 DN] (2225 cm ²)	80	40	160
250	[Pi 33025 DN] (3530 cm ²)	[Pi 35025 DN] (3530 cm ²)	[Pi 36025 DN] 973.643.0 (3530 cm ²)	[Pi 37025 DN] 976.688.2 (3530 cm ²)	[Pi 38025 DN] (3530 cm ²)	80	40	250
400	[Pi 33040 DN] (5900 cm ²)	[Pi 35040 DN] 618.074.9 (5900 cm ²)	[Pi 36040 DN] (5900 cm ²)	[Pi 37040 DN] 611.436.7 (5900 cm ²)	[Pi 38040 DN] 613.180.9 (5900 cm ²)	80	40	400
630	[Pi 33063 DN] 930.810.7 (8685 cm ²)	[Pi 35063 DN] 794.370.7 (8685 cm ²)	[Pi 36063 DN] 799.915.4 (8685 cm ²)	[Pi 37063 DN] 794.371.5 (8685 cm ²)	[Pi 38063 DN] 796.340.8 (8685 cm ²)	100	60	400
1000	[Pi 33100 DN] (13550 cm ²)	[Pi 35100 DN] 794.373.1 (13550 cm ²)	[Pi 363100 DN] 822.956.9 (13550 cm ²)	[Pi 37100 DN] 794.374.9 (13550 cm ²)	[Pi 38100 DN] 797.746.5 (13550 cm ²)	100	60	630

Nominal-size	Drq vst 10	Drq vst 25	Drq vst 40	Drq vst 60	Drq vst 100	Measures in mm		
	Δp 210 bar	Δp 210 bar	Δp 210 bar	Δp 210 bar	Δp 210 bar	A	B	D
40	[Pi 83004 DN] (445 cm ²)	[Pi 85004 DN] 973.746.1 (445 cm ²)	[Pi 86004 DN] 826.658.7 (445 cm ²)	[Pi 87004 DN] 971.394.2 (445 cm ²)	[Pi 88004 DN] (445 cm ²)	45	22	100
63	[Pi 83006 DN] (780 cm ²)	[Pi 85006 DN] (780 cm ²)	[Pi 86006 DN] (780 cm ²)	[Pi 87006 DN] 838.068.5 (780 cm ²)	[Pi 88006 DN] (780 cm ²)	45	22	160
100	[Pi 83010 DN] (1275 cm ²)	[Pi 85010 DN] 975.587.7 (1275 cm ²)	[Pi 86010 DN] 935.988.6 (1275 cm ²)	[Pi 87010 DN] 971.423.9 (1275 cm ²)	[Pi 88010 DN] (1275 cm ²)	45	22	250
160	[Pi 83016 DN] (2805 cm ²)	[Pi 85016 DN] (2805 cm ²)	[Pi 86016 DN] (2805 cm ²)	[Pi 87016 DN] (2805 cm ²)	[Pi 88016 DN] 610.650.4 (2805 cm ²)	80	40	160
250	[Pi 83025 DN] (4900 cm ²)	[Pi 85025 DN] (4900 cm ²)	[Pi 86025 DN] (4900 cm ²)	[Pi 87025 DN] 838.119.6 (4900 cm ²)	[Pi 88025 DN] 618.067.3 (4900 cm ²)	80	40	400
400	[Pi 83040 DN] (4900 cm ²)	[Pi 85040 DN] (4900 cm ²)	[Pi 86040 DN] (4900 cm ²)	[Pi 87040 DN] 838.119.6 (4900 cm ²)	[Pi 88040 DN] 618.067.3 (4900 cm ²)	80	40	400
630	[Pi 83063 DN] (8685 cm ²)	[Pi 85063 DN] (8685 cm ²)	[Pi 86063 DN] (8685 cm ²)	[Pi 87063 DN] (8685 cm ²)	[Pi 88063 DN] (8685 cm ²)	100	60	400
1000	[Pi 83100 DN] (13550 cm ²)	[Pi 85100 DN] (13550 cm ²)	[Pi 86100 DN] (13550 cm ²)	[Pi 87100 DN] (13550 cm ²)	[Pi 88100 DN] (13550 cm ²)	100	60	630

3IVI 11/2001

Data is subject to change without notice